

MOX-SPIL-1306

MoxiE[®]
INDUCTOR CORPORATION

Surface Mount Shielded Power Inductors

MoxiE's SPIL-1306 series of surface mount shielded power inductors are widely used in PDA's, notebooks, LCD televisions and digital cameras.

Features:

- Low Cost.
- Flat top for pick & place machines.
- Available Tolerances: $\pm 10\%$ & $\pm 20\%$.
- RoHS Compliant.
- Magnetically Shielded Applications.



NOTES



MECHANICAL DIMENSIONS

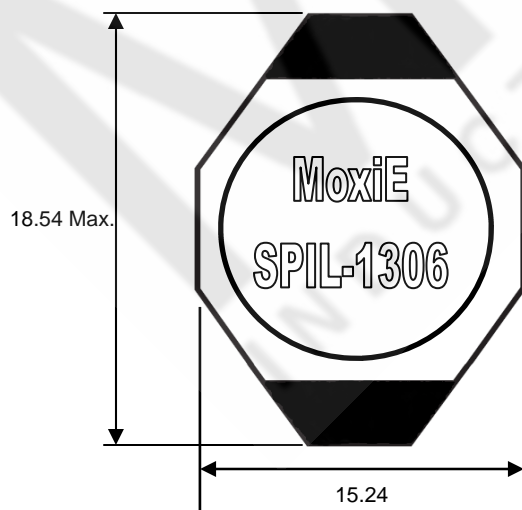

All dimensions in mm.

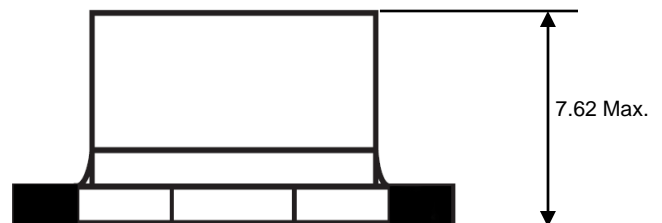

MoxiE Marking: Inductance & Tolerance



LANDING PATTERN

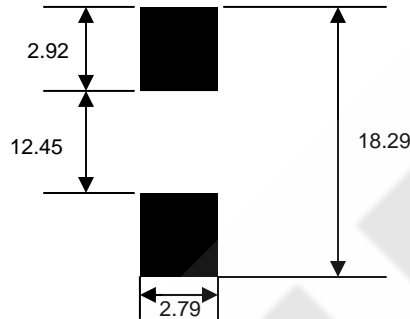

ELECTRICAL SPECIFICATIONS

Part Number	Inductance (µH)	Tolerance (%)	DCR (Ω) Maximum	IDC Max. (A)	I _{rms} Max. (A)	SRF (MHz) Typ.	L Test Frequency
MOX-SPIL-1306-100M	10	20% (M)	0.040	5.50	3.90	24	100 kHz
MOX-SPIL-1306-150M	15	20% (M)	0.048	4.50	3.40	16	100 kHz
MOX-SPIL-1306-220M	22	20% (M)	0.059	3.50	3.10	14	100 kHz
MOX-SPIL-1306-330M	33	20% (M)	0.075	3.30	2.80	11	100 kHz
MOX-SPIL-1306-470M	47	20% (M)	0.097	2.70	2.40	8.00	100 kHz
MOX-SPIL-1306-680M	68	20% (M)	0.140	2.20	2.00	7.00	100 kHz
MOX-SPIL-1306-101M	100	20% (M)	0.210	1.70	1.70	5.50	100 kHz
MOX-SPIL-1306-151M	150	20% (M)	0.300	1.30	1.30	4.80	100 kHz
MOX-SPIL-1306-221M	220	20% (M)	0.470	1.10	1.10	4.00	100 kHz
MOX-SPIL-1306-331M	330	20% (M)	0.780	0.86	0.86	3.00	100 kHz
MOX-SPIL-1306-471M	470	20% (M)	1.08	0.73	0.73	2.40	100 kHz
MOX-SPIL-1306-681M	680	20% (M)	1.40	0.64	0.64	2.00	100 kHz
MOX-SPIL-1306-102M	1000	20% (M)	2.01	0.53	0.53	1.00	100 kHz



MOX-SPIL-1306 ENGINEERING NOTES

- Measuring Frequency (L) 100 kHz
- Available Tolerances: K = ±10%, M = ±20%
- RoHS Compliant.
- Operating Temperature: -40°C to +85°C.
- Magnetically shielded to prevent noise radiation.
- MoxiE Inductor Corporation specifications are subject to change without notice.